



Making London more sustainable

Year 6 at Dalmain Primary School with Allies and Morrison

Visiting Allies and Morrison

On 22nd September Year 6 visited Allies and Morrison's studios at Bankside. We had a building tour and a drawing workshop where the architects and model makers described their jobs and answered questions.

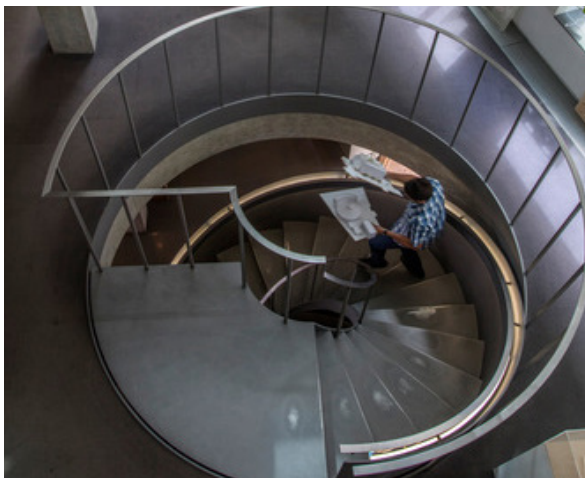

Our more sustainable London

In our own words

Building Our Sustainable London: Our design process:

When we started the project I had the brilliant idea to make a factory powered by hydrogen which we would take from water collected by a water wheel. For this to work the area around the factory must be linked up with water. There was one problem, I didn't know what the factory would produce. For this, I was forced to transform my factory to a functional homeless and food bank but still powered by hydrogen.



The modelling process:

To begin with me and my group made some of the important details which were the hydrogen tank and the water wheel. We then painted the lid of the tank and the water wheel. After, we put sponges in the tank to make it seem like hydrogen. Then we made the buildings and used a stick to make the wheel spin we attached everything to our base board and then added bushes and painted all the details.

Reflections: In our own words:

Towards the end of the project our build, The Eco Food Centre (E.F.C) started to come together and resemble the food and homeless shelter and carbon reducing facility we envisioned. That was made to picture a sustainable London. There were many challenges that we would have to adapt to. My original idea was a factory but a challenge we faced was we didn't know what to produce. Although there were hardships, our models have turned into masterpieces. A big thank you to Allie and Morrison and open city.org who supplied us with the resources.

Building Our Sustainable London: Our design process:

One of my designs was meant to be a restaurant, named The Glass Eye. It'd been meant to be made out of glass, steel wires and wood. The design was a glass sphere suspended by steel wires coated in ivory. Instead, my sculpture actually became half a glass sphere on top of a wooden circle. Tables and chairs were popsicle sticks and I surrounded it with lichen and sponge. The wooden circle was propped up by wooden matchsticks which rested on card paper.

The modelling process:

I had these six resources: A glass (really, it was plastic) sphere, paper wooden slats, faux lichen and grass, and matchsticks, thanks to Open City company. I used super glue to fuse the sphere to the slats, and tables and chairs were painstakingly, meticulously glued to the slats, using lollipop sticks and matchsticks. I was so relieved that the architects of Allie and Morrison were there to help and provide me with this knowledge. Thank you!

Reflections: In our own words:

This project was so inspiring for me because I could almost design my dream house, and it could channel my creativity into one building. Not only that, but the thought of being able to create something 3D and where people could look at, and think, that looks so amazing! I want to live inside that!

It was probably one of my favorite art lessons throughout my entire time at Deveson. I got to design and create a real 3D building, and even add the details - the tiniest ones of all. I definitely loved that one.

Building Our Sustainable London: Our design process:

My inspiration for the Moss Model was the Bubble Hotel. The first time I saw it, I was amazed at the fabulous work that the previous year 6 children did so I decided that I wanted to make something similar but not the same, and so I then thought of the idea that people grow on the side of buildings. Moss Model, I thought. At first, I imagined it as a glass dome with a couple of trees. But the problem with glass is that it is transparent. Something I usually wouldn't mind other than the fact that when I build it, I would have to make the floor, moss, beds etc.

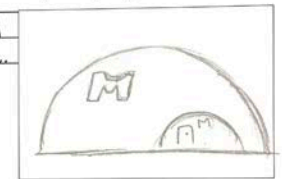

The modelling process:

Modelling the design was one of my favorite parts of this project as a new free to make whatever I wanted to whenever I wanted to. All I needed was any device capable of using CAD software. I enjoyed doing it mainly on the laptops that were thoughtfully provided for us in case we could not do it at home. At the end of the few weeks, I had a grey cylindrical building with another small one right next to it. It was intended to be made of moss, forgoat painted wood and glass.

Reflections: In our own words:

I would like to use this great opportunity to thank everyone who has helped and aided the making of our designs. Especially Allie and Morrison and Open City Org for our resources and for being there to assist the making of the much needed regenerated London that provided for a more sustainable and eco-friendly city.

I am very happy of the result as I only had one day to complete it and I think that I did an absolutely outstanding job for just a singular day that I had to make it. I think I did the best of my abilities.

A more sustainable London

Our design process

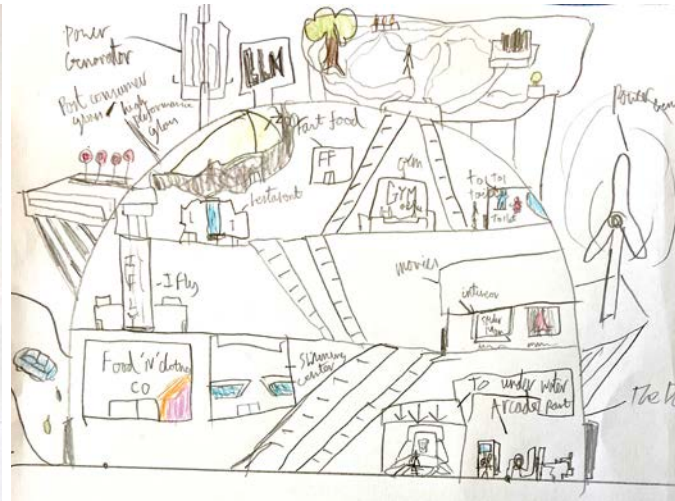
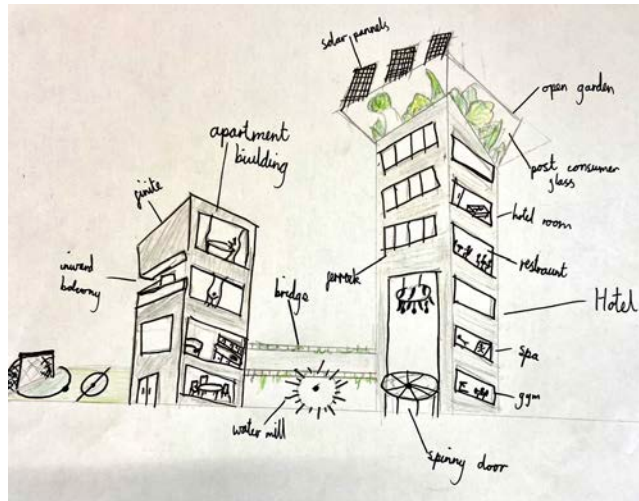
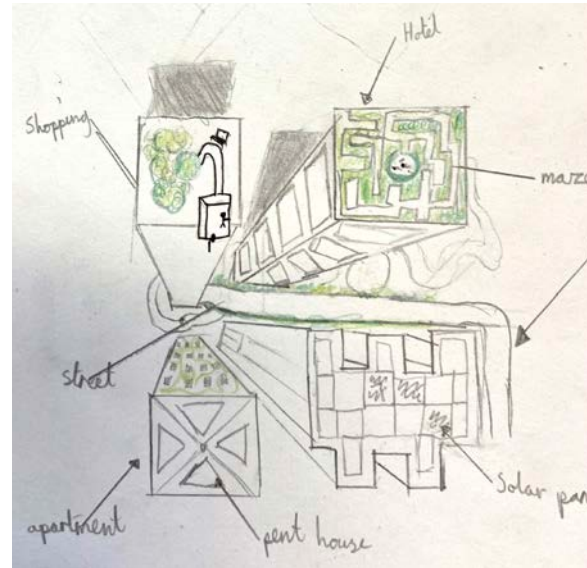

Our more sustainable London

In our own words

Building Our Sustainable London: Our design process:

My group were quite quick when we came up with the initial design however we kept coming up with different things we wanted to add. We knew we wanted to do a hotel, an apartment and a watermill but we didn't know how to incorporate that into one so we decided to create two buildings (a hotel and apartment) connected with a wide bridge that has lots of market stalls and plants. And lastly on the side of one structure there will be a football pitch.

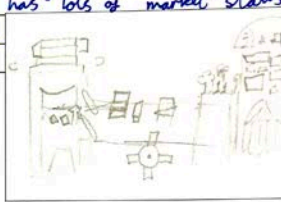

The modelling process:

When we started my group jumped right into the building process and started by making two structures, then we cut out some windows and covered one of the models in green card. After that we made a few trees, some bushes and yoga mats which is also where we then put a couple of people doing yoga. My favourite parts were when we put detail, people and window panes in the open spots we'd cut out. Lastly we added some lights and posters that were LGBTQ+ supporting and B.L.M.

Reflections: In our own words:

I am really grateful I had this opportunity to work with Alice and Morrison and for my year to take part in this Open City project. Doing this has helped me realise I actually really like model making especially the tiny fiddly bits like mini flowers and stalls. Working with all these different materials has been extremely interesting as I've never done anything like this before. If we made our model we'd have mainly built it out of porridge and fruit. Our project/building was called Ecoglow.

Building Our Sustainable London: Our design process:

By the end of the project our designs were successful and close to our original plans. We have brought a dream eco city. Our particular design was to make our animals to live culture free. We have created a animal mansion which is a farm to feed and take care of our animals. Our Materials were, Card, dots, wood, trees, astroturf, plastic paper and Finally Moss and Lollysticks.

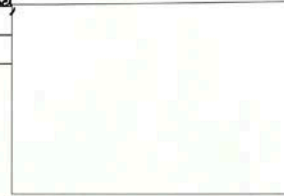

The modelling process:

Our Modeling process was difficult but a great experience for us all. The main part of our Model was our tower to keep our animals safe and our entire 3D design was to make it clear so everyone could see them so we used Mirror Card. Our domes were made of plastic shot glasses which went on top. Our Fences were made from flicks wood and our water features from domes.

Reflections: In our own words:

Without a doubt I would like to live in this eco city as all of these builds are amazing and then just like the real world but more adventurous. I would like to take this opportunity to thank both Alice and Morrison and open city for providing us with this incredible opportunity. From taking this opportunity to thank both Alice and Morrison for making me feel creative and confident in art. It makes me feel all in with love and passion for art. This Project makes me want to be more of an artist.

Building Our Sustainable London: Our design process:

My building is a dinner hall and shopping but I had intended for it to be a more theme my group but I all had really liked this but we made them more so that it could start our model. Firstly, I planned my project and started drawing in art. As soon as I finished we looked at the other groups work and started putting color on our drawings. I planned for my building to be it was only be made out of resources including wood and stones.

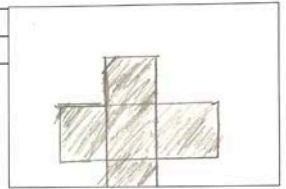

The modelling process:

Firstly we started putting our prototype models on the base board so that we could get an idea of our city. Then the lovely architects from Alice and Morrison and our completely talented two opening people, over the next few weeks we gradually improved and perfected our models until we were here. My model was inspired by being able to have an eco-friendly alternative to shopping our food hall has vegans and vegetarians options and all the hall is the range and organic. Strong build is called The Dome and is made out of card.

Reflections: In our own words:

This project has been really fun and a great experience. I am thankful for this opportunity to be a class and Morrison and open city. I think that my group did especially well considering it started with three people. I was when we visited the office I felt inspired by Alice and Morrison. I am extremely thankful and grateful for this opportunity as I have been looking forward to it since I first learnt art is. I am also thankful to open city for organising this event.

A more sustainable London

The modelling process

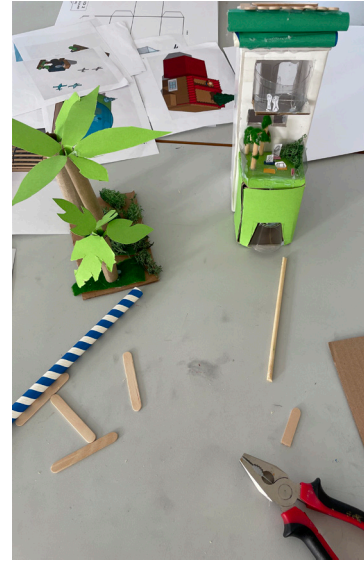

Our more sustainable London

In our own words

Building Our Sustainable London: Our design process:

For our design process, we were making a chain for fast food restaurant which was called Vegdo's. It's like Nando's, but it is all ~~vegan~~ ^{vegan} ~~vegan~~ ^{vegan}. It's an irresistibly good, healthy restaurant, for people who are vegetarian or vegan. We have an eco-friendly place with 100% Natural light because we are made mainly from glass. We also have bamboo for support and very green walls. For the finishing touch, we put on a little carrot for our mascot.



Rated 5-Star 6/5

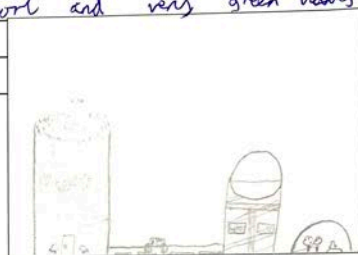

The modelling process:

In our modelling process, we cut off the top off the big bottle to make a cylinder, and then we made the floors out of cardboard with grass on the top. We also had a waterslide to go on. The waterslide is mainly glass, but the actual slide is made from glassed bamboo.

Reflections: In our own words:

I have many thanks to our organisers, Opencity.Org, and Allies & Morrison for their help. They have done a big favour to us by helping us do our build. I have found out I quite like modelling after this. I liked I also loved our name, which was Vegdo's and Waterslide & Co. It was

\$\$\$

Building Our Sustainable London: Our design process:

My design process started with me thinking of an underwater leisure centre with a shopping centre, a swimming pool and a cinema. As I was drawing it I realised that 2 people in my group had a cinema. I thought of the idea of an underwater garden in an underwater dome. This idea became my final design. The walls are made of strengthened glass and steel while the floor is grass and steel. The pillars on floor one are concrete.



The modelling process:

My modelling process started with me making a dome out of a waterbottle with the lid off. After that, I made the first floor out of grass and cardboard. After that, I added a second floor and connected it to the first one with pillars. Next, I added a swimming pool, some lights and a few more details.

Reflections: In our own words:

In my own words I would like to thank opencity.org and allies and morrison for giving us the opportunity to make these models. I loved making these models and I am really happy with the way it turned out, and my favourite part was all of the tiny details.

Our more sustainable London



Our more sustainable London

In our own words

Building Our Sustainable London: Our design process:

My design process began from the idea of a bobble hotel. I had a concept of having a solar powered roof with a natur park at the top but I soon came to the realisation that the bobbles were way to big for my concept but then I realised that there were nets of cubes and flats when I decided to do cubes

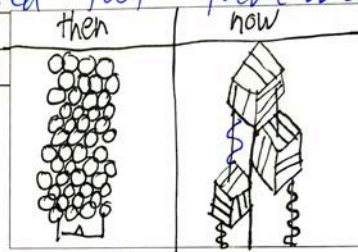

The modelling process:

I traced a net onto peeces of card and then foled and glued metallic stripes of card to creelt a mirror effect and then wrapped piped cleaners around the supports to imitat plants. Intotal I used these materials: Card, metallic card, Pipe cleaners, fake grass, lycum, a straw, lights and lotsof hot glue.

Reflections: In our own words:

In my own words, I want to thank Allies and Morrisons for helping inspire my design; they heavily helped with my modelling process as well. When we visited the office the models inspired both my old and new designs. I'm also going to thank opencity.org for actually organising this contest. I'm so excited for the completion, And display of all of our collection of buildings. I can't thank Allies and Morrisons and Open city enough for the chance for this competition chance.

Building Our Sustainable London: Our design process:

Our ideas were to build a hotel with a big bridge in the middle and a Lesure center at the other end. Are bridge has water and a generator under the water that Powers ~~the building~~ electricity. Our other ideas were to build a roof garden on are ~~to~~ two buildings

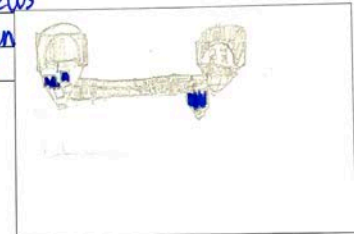

The modelling process:

We made this model by using card and wooden bits that we stuck to bits of are model for extra detail. The buildings involved us glueing bits on and burning are sets.

Reflections: In our own words:

I enjoyed this because I liked designing the models and making them and thank you Allies and Morrisons and opencity for helping us during this project.

Our more sustainable London

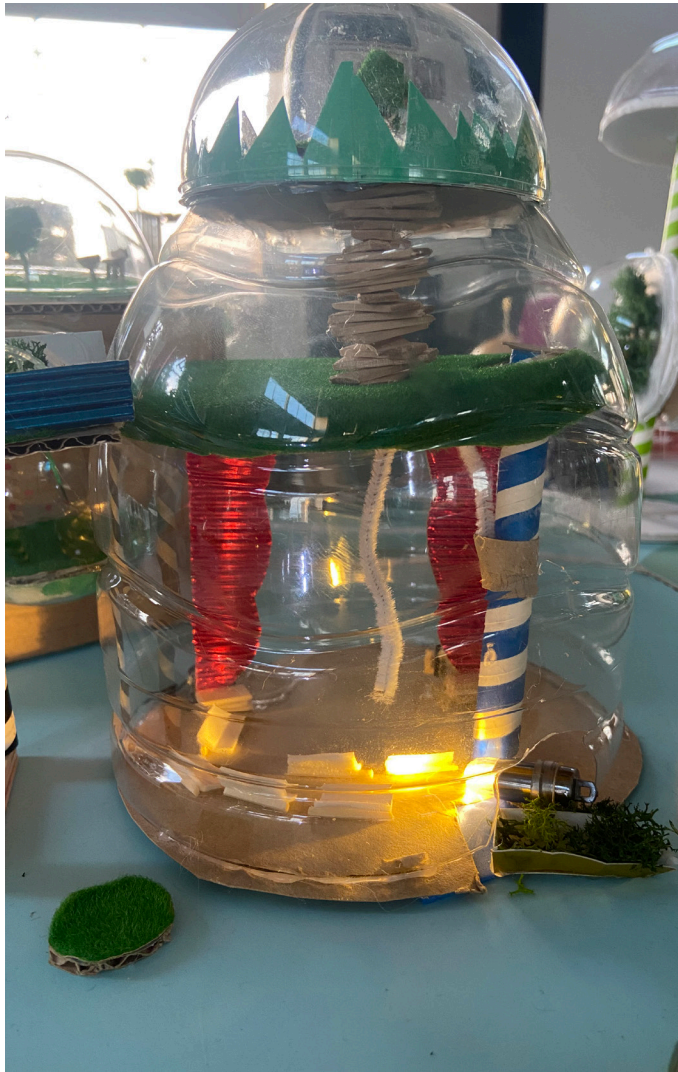

The Dome Leisure Centre: Part of the Autumn Towers Group

Powered by a hydropower plant, it has an underground water garden, theatre, observation platform, indoor and outdoor gardens called 'The Glass Gardens', leisure centre and offers boat tours of the Thames. The entire facility is made of recycled glass and recycled metal.



The Sustainable Sky Garden:

A place to relax and unwind. It is made of recycled glass, filled with tropical plants and has a feng shui rock garden and solar generators.



Stairway to Haven:

Stairway to Haven is a conference space themed for the seasons (it is currently using a Halloween vibe with cobwebs in the trees outside). It has themed entertainment and is made with recycled glass, repurposed railway sleepers and has solar walls.

Our more sustainable London



The Glass Eye Restaurant:

Offering global cuisine with stunning views, each table is enclosed in its own garden booth with ceiling projections from the observatory for stargazing.



Gourmet Burger Palace:

Offering lab grown and vegan burgers better than any other you have ever had!



Farmansion:

The Farm of the century, a place where animals live their best life in harmony with their surroundings, complete with adventure playground to keep them stimulated, organic growing crops and vegetables and the world's largest beehive.

Our more sustainable London



Horizons Greenhouse: Part of the Autumn Towers Group:

Offering leisure facilities to residents of Autumn Towers and greenhouses to gardeners in the local area.

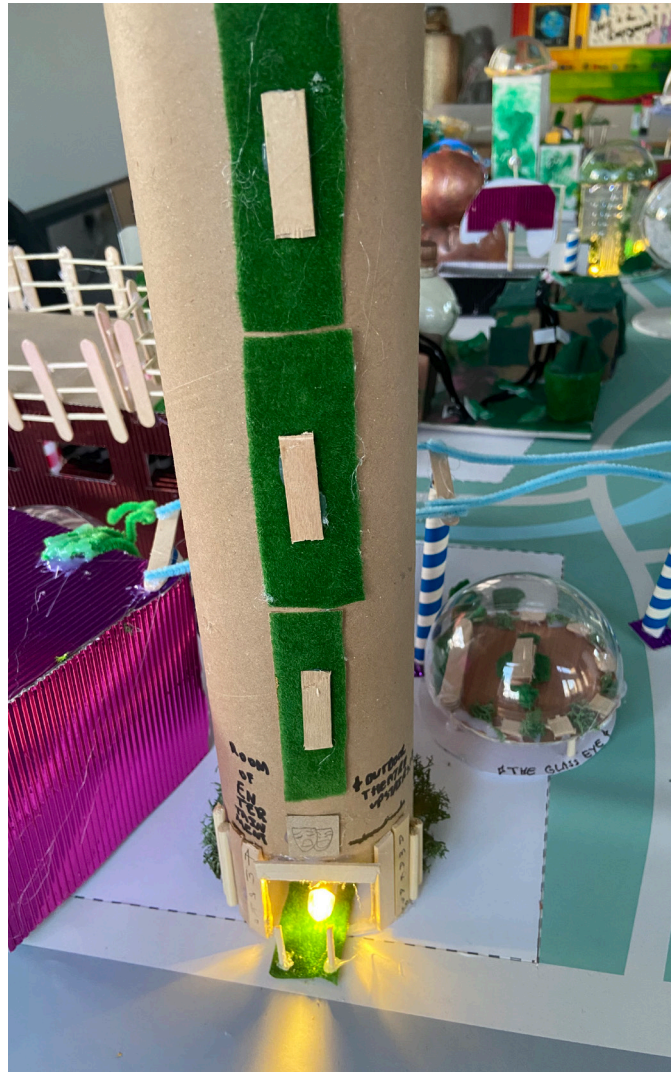

The Entertainment Centre and Theatre:

Multi story theatre and entertainment centre made from repurposed wood and bamboo. Solar panels on the roof provide light to the theatres that have wild gardens growing on the outside walls.



London Museum:

Celebrating the history of London through recordings on a giant screen that retracts in the floor so exhibits can be seen. Includes gardens and café.

Our more sustainable London



The Dome Leisure Centre: Part of the Autumn Towers Group

Powered by a hydropower plant, it has an underground water garden, theatre, observation platform, indoor and outdoor gardens called 'The Glass Gardens', leisure centre and offers boat tours of the Thames. The entire facility is made of recycled glass and recycled metal.



The Great Tower:

Observatory and planetarium made from recycled shipping containers and repurposed metals.



Open Air Glamping Motel & Spa:

A place to unwind in the open air. Docked next to the Thames, it has giant oars that sail down the Thames to watch the stars on clear nights. Includes open air hot springs, gardens and glamping in the open air.

Our more sustainable London



The Dome: Part of the Autumn Towers Group:

The Dome is a restaurant offering the finest cuisine in the world made from eco sourced produce from Farmansion. The restaurant has an open Garden and retractable walls. There are apartments on site. The buildings are repurposed shipping containers.



Vegdo's Restaurant:

Vegdo's is made from 100% sustainable materials including wood, bamboo and recycled glass. It has a moss farm for carbon capture and a waterpark with a glass slide.



The Bamboo Hotel:

Made from sustainable wood and recycled glass, each room has a themed bamboo forest room.

Our more sustainable London



Eco -Glow:

Is a sustainable housing and leisure facility, consisting of a watermill, football pitch and wildflower garden for the bees of Farmansion. Apartments have open roof top gardens. It is sustainable, being constructed of Ferrock, recycled glass and wood. It is powered by its own watermill that is generating electricity from the Thames.

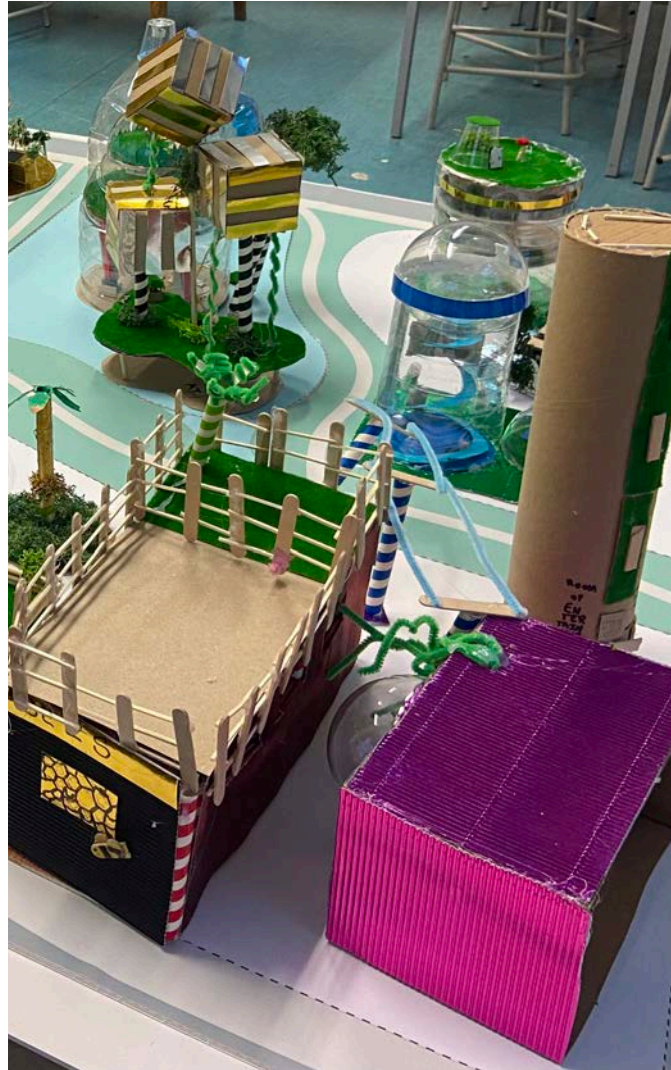

The London Restaurant:

Made from repurposed shipping containers and serving food direct from Farmansion.

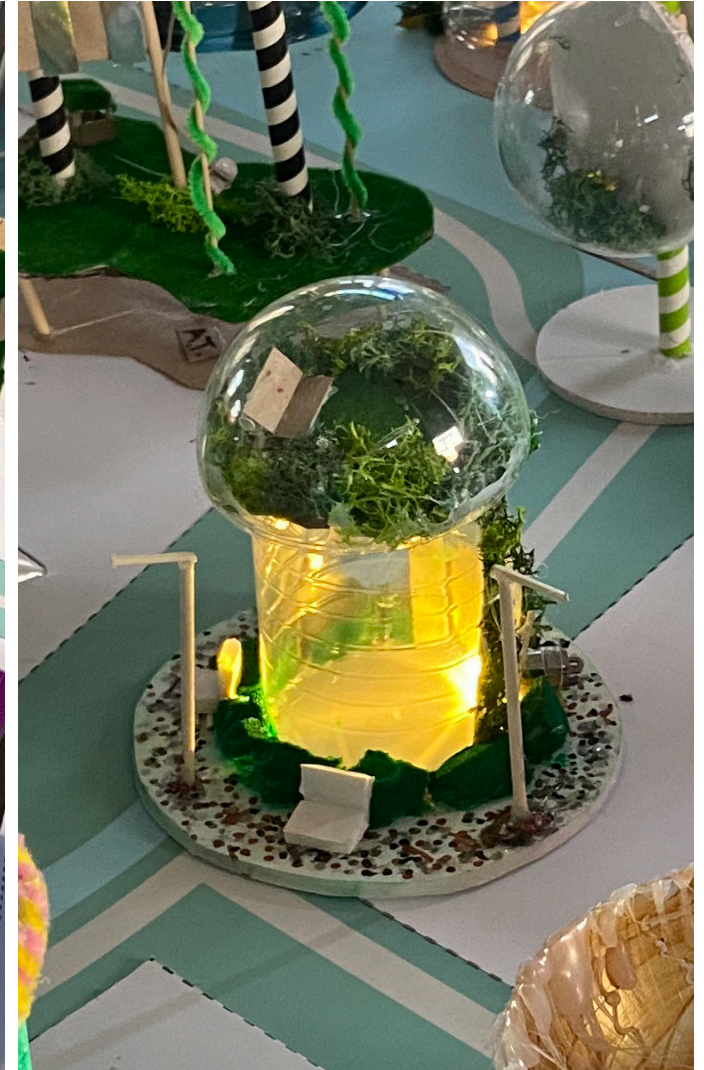

The Moss Hotel:

Five-star accommodation with air purified by the moss walls that extend to the interiors. The largest viewing platform in the world rises on the side for spectacular views of the city. Made from Ferrock and repurposed wood.

Our more sustainable London

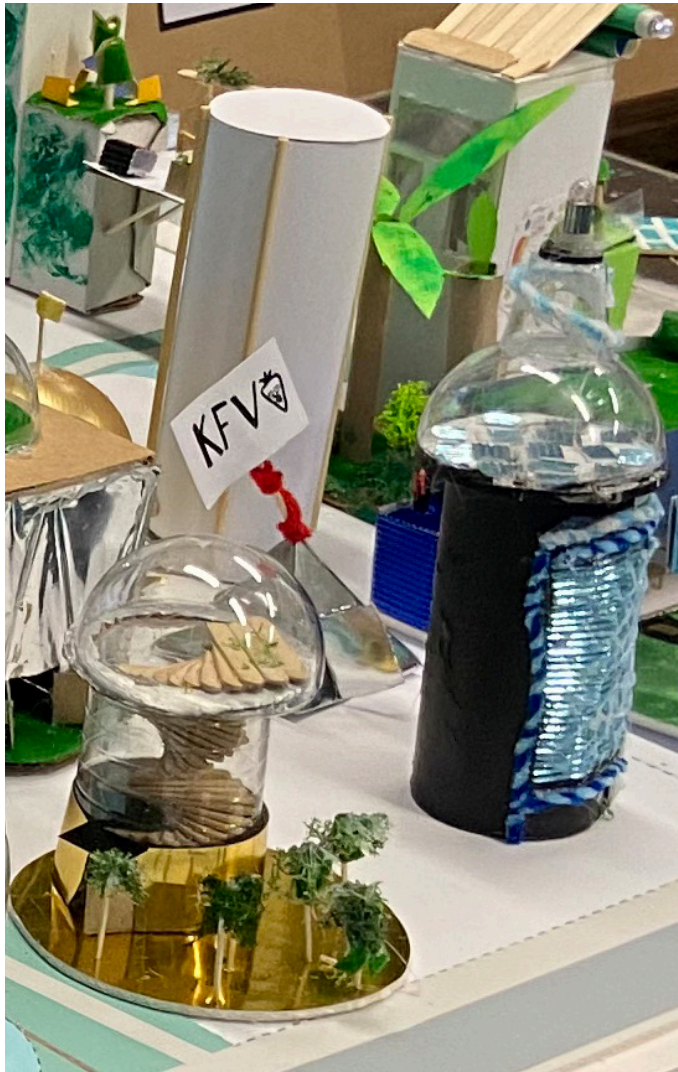

KFV:
Spicy coated fried vegetables for vegan fans. Made from recycled glass and steel.



E- Gamer Arcade:
Made from repurposed shipping containers, a place to play your favourite arcade games and socialise with your friends.

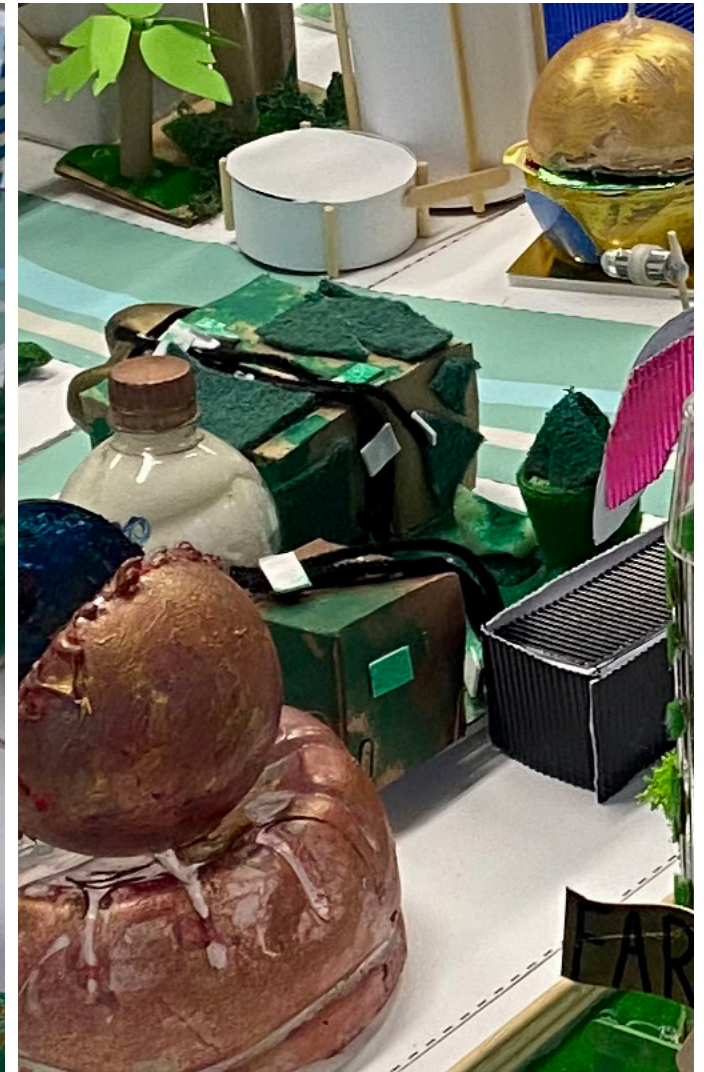

Eco-Food Centre & Carbon Capture Facility:
Eco food shopping hall, water mill and carbon capture facility. Made out of materials that allow moss to thrive on the outer and inner walls.

Our more sustainable London



The Cubes: Part of the Autumn Towers Group:

The Cubes is a sustainable hotel using repurposed furniture and made from recycled steel, sustainable wood and ferrorock. It has a water purifying facility connected to the Thames.

Dear Year 6,

We loved coming into school and working on your more sustainable London model with you. We were so impressed by your model making skills, hard work and imagination. We were particularly impressed by all the descriptions of your models- they show how much thought have gone into the design and the sustainable features!

Thank you for being such a brilliant and enthusiastic year group to work with.

From Ellie, Gareth, James, Holly and Becky at Allies and Morrison.